

Six
Month
Bid

STATE OF OKLAHOMA
CANADIAN COUNTY
FILED OR RECORDED

MAY 27 2025

SHERRY MURRAY
COUNTY CLERK

250378



July 1, 2025
Thru
December 31, 2025

Approved this 27th day of May, 2025
by the Canadian County Board of Commissioners
Chairman Thomas W. Wank
Member Tracy Rider
Member FRANSON



**Canadian County
Purchasing**

**Six Month Bids
July 1 – December 31, 2025**

Date Issued: May 27, 2025
Bid Number: **SIX MONTH BIDS**
Closing Date: June 13, 2025 at 4:00pm
PO Box 458, 201 N. Choctaw Ave., El Reno, OK 73036
Opening Date: June 16, 2025 during the Commissioner’s Meeting that begins at 9:00am
Commissioner’s Meeting Room, 201 N. Choctaw Ave., El Reno, OK 73036

~ NOTICE TO BIDDERS~

Sealed bids will be received by the Canadian County Purchasing Agent of Canadian County, Oklahoma at the Court House in El Reno until 4:00pm on the 13th day of June, 2025. Bids will open during the Commissioner’s Meeting that begins at 9:00am on the 16th day of June, 2025.

Bids will be opened by the Board of Canadian County Commissioners on that date for the six month period of:
July 1, 2025 through December 31, 2025

All bids must be made on forms furnished by the County, signed and notarized and shall conform to the regulations and conditions contained herein.

The Canadian County Board of County Commissioners reserves the right to reject any all bids or to award all or any portion of the items bid.

Please mail sealed bids to:
Lindsey Garrett, Purchasing Agent
Canadian County Clerk’s Office
PO Box 458
El Reno, OK 73036

Street Address: 201 N. Choctaw Avenue, El Reno, OK 73036

Please mark your envelope “Six Month Bid”

<p>_____</p> <p>_____</p> <p>_____</p>	<p>Lindsey Garrett, Purchasing Agent Canadian County Clerk’s Office PO Box 458 El Reno, OK 73036</p>
<p>SIX MONTH BID Closes: June 13, 2025 at 4:00pm</p>	

If you have any questions or need additional information, please contact:
Lindsey Garrett, Purchasing Agent, 405.295.6125



~TABLE OF CONTENTS~

ITEM:	PAGE:
Bid Regulations and Conditions.....	4
Bid Contents	5
Vendor Performance	6
Affidavit of Non-Collusion	7
Asphaltic Material	17-19
Blended Supplementary Cementitious Materials (SCM)	11
Cement	11
Cement Slurry.....	15
Cold Lay	22
Concrete – Furnished and Unloaded.....	9
Corr. HDPE Pipe	S/C
Corr. Polypropylene Pipe	S/C
Corr. Metal Arched Pipe (See State Contract).....	S/C
Corr. Culvert Pipe (See State Contract)	S/C
Decomposed Granite.....	13
Dust Control.....	14
End Wings(NEW / USED)	8
End Wings-Round Corr. (See State Contract)	S/C
End Wings-Metal Arched Pipe (See State Contract).....	S/C
Fly Ash	12
Forming-Stay in Place	8
Guard Rail – Galvanized (NEW / USED)	8
Guard Rail – Galvanized (See State Contract).....	S/C
GYP – Processed	24



~TABLE OF CONTENTS~

H-Piling8

Hauling of Road Rock.....25

Hot Mix Asphalt20

Hot Mix Asphalt Hauled & In Place.....21

Kiln Dust.....12

Milling Machine Service23

Pipe Piling – New8

Pipe Piling – Used8

Quadrant Map16

Quick Lime13

Railroad Flat Cars.....9

Railroad Tank Cars.....9

Road Rock24

Steel Sheet Piling – Interlocking9

Structural Steel.....8



~BID REGULATIONS AND CONDITIONS~

BIDDERS LIST:

- A. Vendors wishing to do business with the County should be included on the "Bidders List" maintained by the County Purchasing Agent. All vendors are eligible for consideration.
- B. Vendors wishing to be added to the "Bidders List" should contact the County Purchasing Office.
- C. Removal from the "Bidders List".
 1. Removal or Suspension. The Purchasing Agent may remove any vendor on the Bidders List for such period of time deemed necessary by the Purchasing Agent.
 2. Cause for Removal or Suspension. The following shall be deemed sufficient grounds for removal or suspension:
 - a) Three consecutive failures to respond to the Notice to Bidders.
 - b) Failure to submit certificate of compliance when required.
 - c) Consistent failure to conform to bid regulations, conditions, and/or specifications.
 - d) Failure to make timely deliveries.
 - e) Failure to keep bid firm for the time specified on the Notice of Bid.
 - f) Collusion with other bidders or prospective bidders to restrain competitive bidding.
 - g) Bankruptcy or other evidence of insolvency of the bidder.
 - h) Giving false or misleading information in an application for inclusion of the "Bidders List".
 - i) Any violation of these rules and regulations or other information suggesting that the bidder is no longer responsible and qualified to do business with the County.
 3. Notice of removal or suspension from the Bidders List will be sent to affected vendor. This action may be contested in writing to the Purchasing Agent within five working days.

BIDDING PROCEDURES:

- A. Solicitation of Bids.
 1. Concerning Solicitation. The Purchasing Agent provides fair and impartial consideration to all qualified bidders and seeks to obtain the highest practicable degree of full and free competition. All interested vendors are urged to apply for inclusion on the Bidders List.
 2. Bid Selection. The County Commissioners reserves the right to reject any or all bids or award all or any portion of the items bid including awarding by districts on any items bid. The Purchasing Agent will solicit phone bids from three or more vendors selected at random, if this occurs.
- B. Bid Form:
 1. Bids are submitted on the forms containing items and/or goods a vendor wished to bid. Return of bid constitutes a valid offer good for 30 days from the date of opening.
 2. Formal Requirements.
 - a) Written in Ink or Typewritten. All bids must be written legibly in ink or preferably typewritten.
 - b) Authorized Signature. The bid must bear the signature in ink by the person so authorized.
 - c) Notary Seal. Each bid must bear the signature and seal of an authorized Notary Public on the Affidavit of Non-Collusion.
 - d) Labeled and sealed envelope. Bidders name and address and closing date must appear on the face of the envelope.



HOLD HARMLESS AGREEMENT:

All bidders shall defend, indemnify and hold the County of Canadian County, State of Oklahoma, its commissioners, officers, deputies and employees harmless from and against any and all liability, loss, expense (including reasonable attorney's fees), or claims for injury or damages arising from, relating to, or connected with the performance of the bidding work.

BID CONTENTS:

1. **Entire Agreement.** The Bid Regulations and Conditions of this section together with the Notice of Bid and any other sheets or documents made a part of the bid package, shall constitute the entire agreement between parties.
2. **Modification.** An addendum will be issued, when deemed necessary, for any changes in, additions to, or waivers of specifications, or regulations and conditions of the bid. The Purchasing Agent must issue this addendum.
3. **Offer firm for thirty days.** Return of bid constitutes a valid offer guaranteed for a minimum of 30 days by vendor until bid is awarded. After bid is awarded offer is firm for six months.
4. **Items to be new or current.** Unless otherwise stated within the bid, goods and materials offered in the bid are to be new and of current design.
5. **Non-Acceptance of Split Award – “All or None Bid”** – The County Commissioners reserve the right to make and award on items or groups of items listed on the bid. If the vendor wishes to bid “All or None”, this must be clearly shown of the bid.
6. **Shipping Instructions.** Goods and materials are to be shipped F.O.B., the receiving officer or department. All freight is to be borne by the vendor and included in the bid price.
7. **Title and Risk of Loss.** Title of goods shall not pass from the vendor until such goods are received by requisitioning departments receiving officer. Risk of such loss prior to such receipt shall be borne by the vendor.
8. **Delivery.** Time is of the essence and deliveries are to be made within ten days after receipt of an order. Items to be picked up by the County shall be ready within 24 hours of notice.
9. **Inspection and Rejection.** All goods and materials shall be subject to inspection by the receiving officer at the time of delivery. Any goods not in complete conformance with the specifications, defective in materials of workmanship, or found to contain latent defects will be rejected. Such goods are to be removed and replaced by and at the cost of the vendor promptly after notifications of rejection. Risk or loss as to such rejected goods shall be borne by the vendor.
10. **Payment.** Payment by the County for goods received shall not constitute acceptance if subsequent discoveries reveal latent defects or a failure to meet bid specifications. Payment for a period delivery shall not be deemed acceptance of undelivered goods.
11. **Exemption from Taxes.** Purchases made by the County are exempt from State Sales Tax and from Federal Excise Tax. These taxes should not be included in bid prices. When required, the Purchasing Agent will supply the proper tax exemption certificate.

SUBMISSION PROCEDURES:

- A. **Sealed envelopes.** Bids must be submitted in a sealed envelope with the name and address of the vendor and date and time of closing clearly marked on the outside of the envelope.
- B. **Late Bids.** Bids received after the time and date of closing listed on Notice to Bidders will not be opened. These late bids will remain unopened and become a permanent part of the bid file.



AWARDING OF BIDS:

- A. Acceptance. The Purchasing Agent will compile the bids submitted. The County Commissioners will open and consider all bids. The Purchasing Agent will notify all successful bidders in writing prior to onset of the bidding period. **Vendors should not submit bids for items that are not on the six month bid request. Bids will be awarded only for items on the six month bid request.**

Purchases of items and supplies that are on this Six Month Bid list must be made from the vendor listed. This is an exclusive contract between Canadian County and the vendor for the time period mentioned on the "NOTICE TO BIDDERS". The county must be as sincere in fulfilling its obligation by buying from the vendor as it expects the vendor to be in holding the price stable to the bid period.

- B. Grounds for Rejection:
1. Non-Responsive Bid. Any bid which does not meet the requirements or specifications of the bid, or is unsuitable for the intended use, or does not comply with these regulations and conditions may be rejected. The County Commissioners reserve the right to reject any or all bids when such is deemed in the best interest of the County.
 2. Affidavit. The Non-Collusion Affidavit not signed and notarized and/or included with the bid.

PERFORMANCE BY SUCCESSFUL BIDDER:

- A. Delivery of Goods:
1. Deliveries shall be made within **ten days from the date ordered**. Items to be picked up by the County shall be ready within 24 hours of Notice.
 2. Deliveries are to be made to the requisitioning department and the vendor will be advised of such time of order.

SUB-LETTING:

- A. Any bid submitted with sub-letting to firm other than the bidding vendor will or shall be CLEARLY SPECIFIED ON THE BID SHEET.

THE USE OF RECYCLED MATERIALS:

- A. If a vendor has products using recyclable materials and regular materials, the vendor shall submit separate bids, using one bid for recyclable materials only and using one bid for regular materials.

CHANGING OF BID SPECIFICATIONS:

- A. Bid forms shall be filled out as specified. If a Vendor chooses to change the bid specifications, the bid will be subject to rejection by the Board of Canadian County Commissioners.

ALUMINIZED STEEL TYPE "2" PIPE SPECIFICATIONS:

- A. This proposal for furnishing Corrugated Aluminized Steel Type "2" Pipe as per Oklahoma State Highway Specifications, Section 726, 1999 Edition and Supplements, delivered F.O.B. to specified locations in Canadian County. Steel Sheet, aluminum-coated (type 2) by the hot-dip process for sewer and drainage pipe shall conform to the AASHTO M 274.



AFFIDAVIT MUST BE INCLUDED WITH YOUR BID OR BID WILL BE REJECTED BY THE BOARD OF CANADIAN COUNTY COMMISSIONERS.

RETURN THIS PAGE WITH THE BID

~AFFIDAVIT OF NON-COLLUSION OF BIDS~

STATE OF _____)

COUNTY OF _____)

I, the undersigned of lawful age, being first duly sworn on oath say that he or she is the agent authorized by the bidder to submit the attached bid. Affidavit further states that the bidder has not been a party to any collusion among bidders in restraint of freedom of competition by agreement to bid at a fixed price or to refrain from bidding; or with any state official or contract, or in any discussions between bidders and any state official concerning exchange of money or other things of value for special consideration in letting of a contract, that the bidder/contractor has not paid, given or donated or agreed to pay, give or donate to any officer or employee of the State of Oklahoma or other public entity thereof, any money or other thing of value, either directly or indirectly in the procuring of the award of a contract pursuant to this bid.

BUSINESS NAME: _____

ADDRESS: _____

PHONE NUMBER: _____ FAX NUMBER: _____

EMAIL: _____

SIGNATURE: _____

TITLE: _____

(NOTARIZATION)

SUBSCRIBED AND SWORN BEFORE ME THIS _____ DAY OF _____, 20____.

(NOTARY PUBLIC)

(COMMISSION EXPIRATION DATE)

(SEAL)



RETURN ONLY THE PAGES THAT YOU HAVE BID ON
BID PROPOSAL
CANADIAN COUNTY

DATE: _____

NAME OF FIRM: _____

BIDDER AGREES TO COMPLY WITH ALL TERMS AND CONDITIONS OF BID

STAY IN PLACE FORMING OR TENSEL FORM:

(NEW Prime Material: PAINTED) Price per square foot:

- 22 gauge _____
24 gauge _____
26 gauge _____

NEW PIPE PILING: outside diameter – price per foot:

- .50 (1/2) wall thickness
7" _____
7 5/8" _____
8 5/8" _____
9 5/8" _____
10 3/4" _____
12" _____
14" _____

USED PIPE PILING: outside diameter – price per foot:

- .50 (1/2) wall thickness
7" _____
7 5/8" _____
8 5/8" _____
9 5/8" _____
10 3/4" _____
12" _____
14" _____

GALVANIZED GUARD RAILS: (NEW) per 12.6 ft. section: _____ (NEW) per 25 ft. section: _____
(NEW) per 12.6 ft. section Installed: _____ (NEW) per 25 ft. section Installed: _____

GALVANIZED GUARD RAILS: (USED) per 12.6 ft. section: _____ (USED) per 25 ft. section: _____
(USED) per 12.6 ft. section Installed: _____ (USED) per 25 ft. section Installed: _____

END WING: (NEW) price for each _____ (USED) price for each _____

STRUCTURAL STEEL: A 36 GRADE OR BETTER

- (USED) _____ price per pound 3" to 6" angles, channels and flats
(NEW) _____ price per pound 3" to 6" angles, channels and flats
(NEW) _____ price per pound for 6" to 24" wide flange beams
(NEW) _____ price per pound for 25" to 36" wide flange beams

10 x 10 x 42 # H-PILING: (NEW) price per pound: _____

RESPECTFULLY SUBMITTED BY: _____



RETURN ONLY THE PAGES THAT YOU HAVE BID ON
BID PROPOSAL
CANADIAN COUNTY

DATE: _____

NAME OF FIRM: _____

BIDDER AGREES TO COMPLY WITH ALL TERMS AND CONDITIONS OF BID

INTERLOCKING STEEL SHEET PILING: price per square foot:

Table with 7 columns: GAUGE, (18" BLACK), (18" GALVANIZED), (19.7" BLACK), (19.7" GALVANIZED), (21.7" BLACK), (21.7" GALVANIZED). Rows include 7 gauge, 8 gauge, 10 gauge, 12 gauge.

CONCRETE: FURNISHED AND UNLOADED; PRICE PER CUBIC YARD: (All current ODOT specifications apply including water/cement and air content)

Table with 5 columns: PSI STRENGTHS, C, A, AA, AA High Early. Rows include GEARY, OKARCHE, PIEDMONT, CALUMET, EL RENO, YUKON, MAPLE, WALNUT, UNION CITY, MUSTANG.

VENDOR'S PRICE PER HOUR OF HOLDING TIME: \$ _____

WHEN DOES HOLDING TIME BEGIN? _____

IS THERE A MINIMUM ORDER AMOUNT TO PREVENT FREIGHT CHARGES? ___YES ___NO

WHAT IS THE MINIMUM ORDER AMOUNT? _____

VENDOR'S TIME FOR DELIVERY ONCE ORDER IS PLACED? _____

VENDORS BIDDING ON CONCRETE SHALL USE THE ENCLOSED TRUCKING DISTRICT MAPS FOR EACH LOCATION. THE PRICE BID PER LOCATION LISTED WILL BE USED IN THE BOUNDARY AREA.

INSURANCE: SUCCESSFUL BIDDER WILL BE REQUIRED TO PROVIDE ASSURANCE TO INDEMNIFY AND SAVE HARMLESS THE COUNTY FROM ANY LIABILITY OR DAMAGE TO PRIVATE OR PUBLIC PROPERTY OF LIFE SUSTAINED IN THE PROCESS OF TRANSPORTING.

RAILROAD TANK CARS WITH THE ENDS REMOVED-TANK CARS SHALL BE READY TO INSTALL. PRICE SHOULD INCLUDE DELIVERY.

PRICE PER FOOT: 8' _____ 8' 6" _____
9' _____ 9' 6" _____

1/2 TANK DELIVERED WITH MINIMUM 15" WIDE CHANNEL IRON FOOTERS, MINIMUM 3/4"THICK. PRICE SHOULD INCLUDE DELIVERY.

PRICE PER FOOT: 8' _____ 8' 6" _____
9' _____ 9' 6" _____

RESPECTFULLY SUBMITTED BY: _____



RETURN ONLY THE PAGES THAT YOU HAVE BID ON
BID PROPOSAL
CANADIAN COUNTY

DATE: _____

NAME OF FIRM: _____

BIDDER AGREES TO COMPLY WITH ALL TERMS AND CONDITIONS OF BID

Soil Stabilization Materials:

Cement:

All Cement for soil stabilization shall meet the following:

Standard Specifications for: Portland Cement (ASTM C150 or AASHTO M85) or

Standard Specification for: Blended Hydraulic Cement (AASHTO C595 or AASHTO M240) or

Standard Specification for: Hydraulic Cement (ASTM C 1157)

Delivery of cement shall be made in Pneumatic trailers equipped with spreader bars that spread the material uniformly on the roadway. The cost of spreading the cement shall be included in the delivered cost of the material. Must meet current ODOT specifications.

Fly ash:

Fly ash should conform to AASHTO M295 Class C or Class F materials. No bottom ash or Fly ash that is not approved by the Oklahoma Department of Transportation will be accepted. Delivery of the material shall be quoted in end dump trucks with an alternate price delivered in a pneumatic trailer and spread with a spreader bar. Must meet current ODOT specifications.

Lime:

Lime shall be quick lime in accordance with AASHTO M 216 with an available lime index of at least 90% as per ASTM C 25. Only quicklime from sources approved by the Oklahoma Department of Transportation will be allowed. Hydrated lime will not be allowed. Lime shall be delivered in bottom drop pneumatic trailers. Must meet current ODOT specifications.

Cement Kiln Dust:

Cement Kiln Dust being a byproduct of the manufacture of cement should conform to the following specifications: When Tested by AASHTO T 405 the lower limits of the average of chemical properties of the material should meet or exceed the following specifications for one month before shipment. Must meet current ODOT specifications.

CKD Requirements

Calcium Oxides = greater than 35%

Alkali Equivalents = less than 8%

Total Sulfates = less than 10%

Loss on Ignition test = less than 30%

The vendor shall provide current tests report before shipment of the material to the county. Delivery of the material shall be quoted in end dump trucks with an alternate price delivered in a pneumatic trailer and spread with a spreader bar.

All vendors shall supply the name and contact information of a customer service representative to assist with installation questions and installation specifications for the materials quoted.

The material costs delivered to the following zones shall include all costs, not limited to: loading costs, fuel surcharges, toll fees, etc.



RETURN ONLY THE PAGES THAT YOU HAVE BID ON
BID PROPOSAL
CANADIAN COUNTY

DATE: _____

NAME OF FIRM: _____

BIDDER AGREES TO COMPLY WITH ALL TERMS AND CONDITIONS OF BID

PRODUCT PRICE PER TON

And AREA:

Blended Supplementary Cementitious Materials (SCM):

(May contain varying amounts of Cement, Cement Kiln Dust and Fly Ash)

SCM: (Delivered in End Dump Trucks)

- Geary
Okarche
Piedmont
Calumet
El Reno
Yukon
Maple
Walnut
Union City
Mustang

Material Source: _____

Representative: _____

Contact Phone# _____

24 Hour Phone# _____

Up charge for pneumatic freight including spread fees \$ _____ cost per ton.

Notice required to vendor prior to delivery _____ hours.

Does the Vendor agree to deliver product within a two hour time window YES _____ NO _____

PRODUCT PRICE PER TON

And AREA:

CEMENT: (Pneumatic freight including spread fees)

- Geary
Okarche
Piedmont
Calumet
El Reno
Yukon
Maple
Walnut
Union City
Mustang

Material Source: _____

Representative: _____

Contact Phone# _____

24 Hour Phone# _____

Notice required to vendor prior to delivery _____ hours.

Does the Vendor agree to deliver product within a two hour time window YES _____ NO _____

RESPECTFULLY SUBMITTED BY: _____



RETURN ONLY THE PAGES THAT YOU HAVE BID ON
BID PROPOSAL
CANADIAN COUNTY

DATE: _____

NAME OF FIRM: _____

BIDDER AGREES TO COMPLY WITH ALL TERMS AND CONDITIONS OF BID

PRODUCT

PRICE PER TON

And AREA

FLY ASH:

(Delivered in End Dump Trucks)

- Geary
Okarche
Piedmont
Calumet
El Reno
Yukon
Maple
Walnut
Union City
Mustang

Material Source: _____

Representative: _____

Contact Phone# _____

24 Hour Phone # _____

Up charge for pneumatic freight including spread fees \$ _____ cost per ton.

Notice required to vendor prior to delivery _____ hours.

Does the Vendor agree to deliver product within a two hour time window YES _____ NO _____

PRODUCT

PRICE PER TON

And AREA:

KILN DUST:

(Delivered in End Dump Trucks)

- Geary
Okarche
Piedmont
Calumet
El Reno
Yukon
Maple
Walnut
Union City
Mustang

Material Source: _____

Representative: _____

Contact Phone# _____

24 Hour Phone# _____

Up charge for pneumatic freight including spread fees \$ _____ cost per ton.

Notice required to vendor prior to delivery _____ hours.

Does the Vendor agree to deliver product within a two hour time window YES _____ NO _____

RESPECTFULLY SUBMITTED BY: _____



RETURN ONLY THE PAGES THAT YOU HAVE BID ON
BID PROPOSAL
CANADIAN COUNTY

DATE: _____

NAME OF FIRM: _____

BIDDER AGREES TO COMPLY WITH ALL TERMS AND CONDITIONS OF BID

PRODUCT PRICE PER TON

And AREA:

QUICK LIME: (Delivered in bottom drop pneumatic trailers)

- Geary _____
- Okarche _____
- Piedmont _____
- Calumet _____
- El Reno _____
- Yukon _____
- Maple _____
- Walnut _____
- Union City _____
- Mustang _____

Material Source: _____

Representative: _____

Contact Phone# _____

24 Hour Phone# _____

Notice required to vendor prior to delivery _____ hours.

Does the Vendor agree to deliver product within a two hour time window YES _____ NO _____

PRODUCT PRICE PER TON

DECOMPOSED GRANITE:

(please specify pit)

(All Current ODOT Specifications Apply)

FOB _____ FOB _____ FOB _____

Price per ton: \$ _____ \$ _____ \$ _____

RESPECTFULLY SUBMITTED BY: _____



RETURN ONLY THE PAGES THAT YOU HAVE BID ON
BID PROPOSAL
CANADIAN COUNTY

DATE: _____

NAME OF FIRM: _____

BIDDER AGREES TO COMPLY WITH ALL TERMS AND CONDITIONS OF BID

PRODUCT:

DUST CONTROL FOR AIRBORNE SOIL PARTICLES AND AGGREGATES

Price Per Gallon

\$_____ Material and Delivery

\$_____ Material and Placement

Description:

A measured proportion of product is mixed with water and applied with a distributor truck or trailer. The distributor vehicle must be equipped with pumps, spray nozzles and gauges that control and apply the correct dosage rate based on soil description. The distributor system must apply a predetermine amount of gallons per minute of product.

Material:

Product needs to be an emulsified organic base material that is biodegradable. A non-hazardous, non-corrosive material that is environmentally friendly and water soluble.

Equipment:

A distributor vehicle that is equipped with a tank and spray bar. A pump driven system transfers the product from the tank to the spray bar. The spray bar is fitted with fan nozzles spaced every 18 inches at a height 10 to 18 inches above grade.

Product storage can be kept in a leak proof, weather tight container.

RESPECTFULLY SUBMITTED BY: _____



RETURN ONLY THE PAGES THAT YOU HAVE BID ON
BID PROPOSAL
CANADIAN COUNTY

DATE: _____

NAME OF FIRM: _____

BIDDER AGREES TO COMPLY WITH ALL TERMS AND CONDITIONS OF BID

CEMENT SLURRY FOR SOIL STABILIZATION

Price per DRY/TON:

- \$ _____ Quadrant 1: Canadian Rd to Calumet Rd / Waterloo Rd to I-40
- \$ _____ Quadrant 2: Calumet Rd to Highway 81 / Waterloo Rd to I-40
- \$ _____ Quadrant 3: Highway 81 to County Line Rd/ Waterloo Rd to I-40
- \$ _____ Quadrant 4: Canadian Rd to Calumet Rd / I-40 to 89th St SW
- \$ _____ Quadrant 5: Calumet Rd to Highway 81 / I-40 to 104th St SW
- \$ _____ Quadrant 6: Highway 81 to County Line Rd / I-40 to 134th St SW

Map on next page

SPECS FOR CEMENT SLURRY:

DESCRIPTION

This material shall be delivered and applied into or onto the subgrade soil by the supplier at the specified rate determined by the County. Prior to delivery and application, the Supplier may be required to provide cement samples for laboratory testing to be mixed with native subgrade soil from the project site. The County will perform the required work to prepare the subgrade soil for application of the cement slurry, mix the cement slurry into the soil and perform the final shaping and compaction of the cement slurry modified subgrade soil.

MATERIALS

Cement shall conform to the requirements of ASTM C150/150M. Cement powder being used for slurry shall be stored in a weatherproof storage unit to prevent lumps, caking of cement and contamination of any foreign matter that may be deleterious to slurry mix.

The slurry mix shall contain a minimum of 55% cementitious material by mass.

The slurry mix shall contain a stabilizing agent capable of maintaining a homogenous mixture of cementitious material, in water, for a minimum of four hours after it has been batched.

MATERIAL TESTING

If tested, a 500 ml portion of the slurry will be removed from the middle of the load. The slurry suspension will be monitored with no vibration or agitation at ambient temperature for 30 minutes. Little or no separation of liquid or solid should occur. The Marsh Funnel Viscosity of the slurry shall be a minimum of 60 seconds when measured according to ASTM D6910

EQUIPMENT

The slurry plant shall be a hydraulic/pneumatic mixing plant with monitoring devices to regulate flow rates and line pressures. Slurry proportion shall be regulated by calibrated scales. All components of the slurry solution shall be mixed using a high energy static mixing apparatus. All mechanical mixing must be pump driven. Lime slaking tanks, paddle driven mixers and other similar technology shall not be employed.

The slurry plant should provide safe and easy access for the Engineer to obtain samples.

The cement slurry shall be delivered to the project site in a non-baffle tank vehicle that does not recirculate or agitate the slurry material by any means other than the motion of the vehicle in normal movement. Application of the cement slurry shall be uniformly placed onto or into substrate soil. The vehicle that places the slurry shall spread controlled slurry within a given area. Tickets shall be generated through the function of calibrated plant scales for the amount (per ton) of dry cementitious product delivered to the project site.

MEASUREMENT AND PAYMENT

Cement slurry for soil stabilization shall be measured by the dry ton of cement delivered and applied to the subgrade soil and shall include cement samples for laboratory testing. The County shall provide the supplier with water for slurry vehicle, tankers and an area to clean slurry vehicle.

RESPECTFULLY SUBMITTED BY: _____

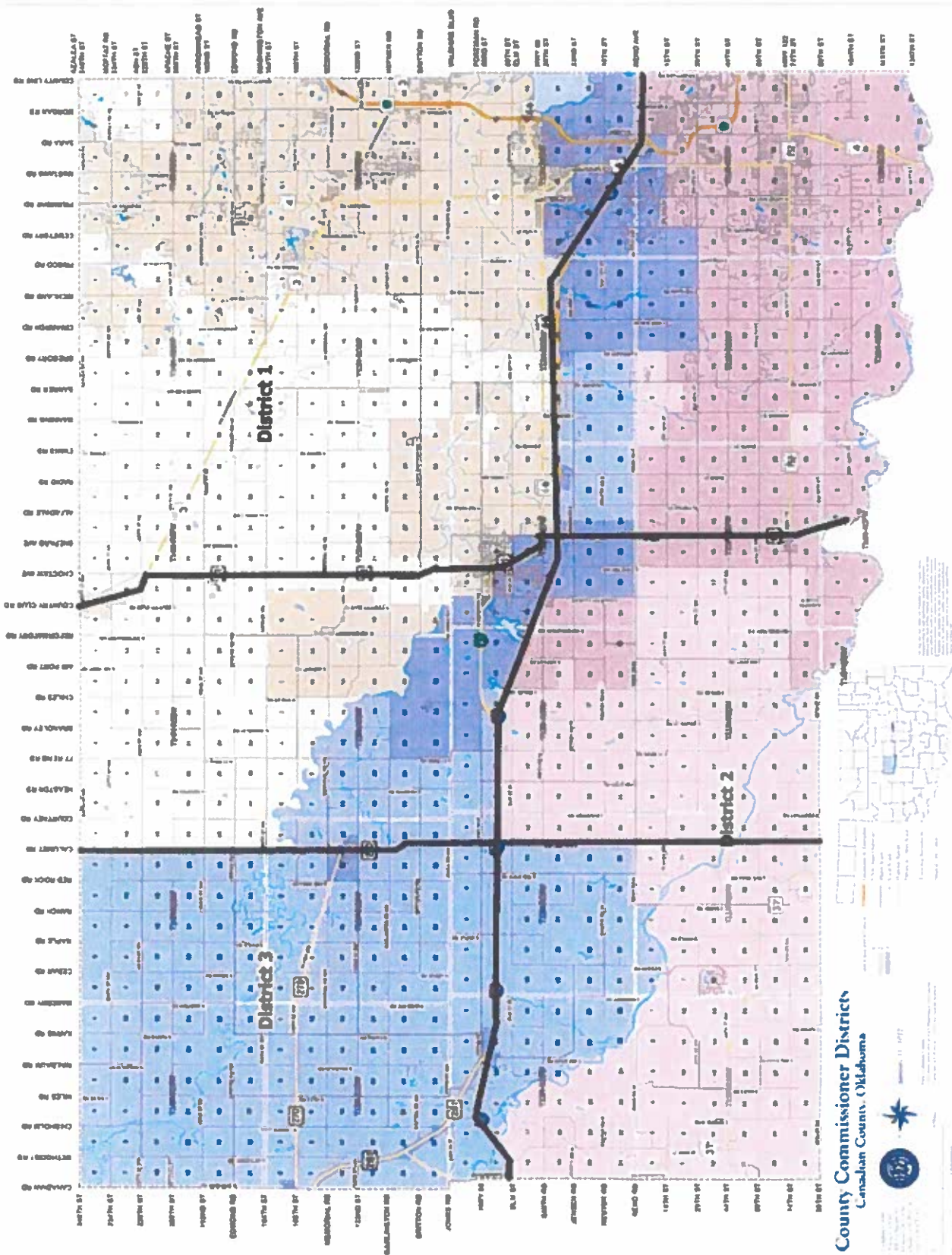



RETURN ONLY THE PAGES THAT YOU HAVE BID ON
BID PROPOSAL
CANADIAN COUNTY

DATE:
NAME OF FIRM:

BIDDER AGREES TO COMPLY WITH ALL TERMS AND CONDITIONS OF BID

ASPHALTIC MATERIALS

FOB CANADIAN COUNTY JOBSITE PRICE PER GALLON:

(Must meet current ODOT specifications)

- AC 7.5 MINIMUM LOAD
AC 20
SS 1 DEMURRAGE CHARGE
SS 1H
CRS 2
MS 2
CMS 1 PUMP CHARGE
CRS2+
AEP APPLICATION OF MATERIALS:
CRS-2S PER GALLON \$
CQS-1F
CHFRS-2P
TR-Fog
CSS-1
CSS-1H
CMS-1PC
CMS-1PF
HFMS-2L
HFRS-2L

PRICES FOR PICKUP at plant location address:

- AC 7.5
CRS-2S
CRS 2
CRS2+
TR-Fog
SS 1
CQS-1F
CSS-1
CSS-1H
CHFRS-2P
CMS-1PC
CMS-1PF
HFMS-2L
HFRS-2L
AEP

Specs on pages 18 & 19

RESPECTFULLY SUBMITTED BY:



SPECS FOR CRS2+ [EMULSIFIED ASPHALT PRODUCT]

<u>TEST ON EMULSION</u>	<u>TEST PROCEDURE (AASHTO)</u>	<u>SPECIFICATION</u>	
		<u>(MIN)</u>	<u>(MAX)</u>
Viscosity, Saybolt Furol @ 122°F, SFS	T59	125	400
Settlement test, 5 day %	T59		< 5%
Particle Charge Test	T59		positive
Sieve test, %	T59		< .10
Demulsibility, 35mL 0.08N DSS solution, %	T59	> 60	
Oil distillate, by volume of emulsion, %	T59		< 2
 <u>TEST ON RESIDUE FROM DISTILLATION</u>			
Penetration, 77°F	T49	100	200
Elastic Recovery, 50°F, %	T301	> 35	

*Exception to T59: Bring the temperature on the lower thermometer slowly to 350°F. Maintain at this temperature for 20 minutes. Complete total distillation in 60 minutes +/- 5

SPECS FOR CQS-1F & CHFRS-2P

CQS-1F

CQS-1F is a cationic emulsified asphalt product for use as a fast breaking, fast curing emulsion for use in fog seal applications. It shall be capable of allowing return to traffic (non-turning) in less than 1 hour at temperatures above 25°C and less than 50% humidity. It shall be delivered to the jobsite in a ready-to-apply dilution not to exceed water to residual asphalt ratio of 60:40. Application rate shall vary according to the demands of the pavement but shall typically be in the range of 0.08-0.12gal/s.y for use on chip seals, and 0.05-0.12 gal/s.y. over bituminous mixtures.

<u>Test on Emulsion</u>	<u>Method</u>	<u>Min.</u>	<u>Max.</u>
Viscosity @ 25°C, SSF	ASTM D88	40	500
Sieve Test, %	ASTM D244		0.10
24-Hour Storage Stability, % (Note 1)	ASTM D244		1
Residue from Distillation @ 260°C, %	ASTM D244	60	
Oil portion from distillation ml of oil Per 100 g emulsion (Note 2)	ASTM D244		1
Emulsion Particle Charge	ASTM D244	positive	
 <u>Test on Residue from Distillation:</u>			
Penetration @ 25°C, 100 g, 5 sec, dmm	ASTM D5	40	120

(CONTINUED ON PAGE 19)



SPECS FOR CQS-1F & CHFRS-2P Continued

CHFRS-2P

Description: A high-float, polymer-modified cationic water-based emulsified asphalt product primarily used for chip seals.

Properties:

Boiling Point	212°F
% Volatiles	None
Appearance	Brown Liquid
Flammability	Non-Flammable
Density	8.4 lbs/gal
Solubility	Soluble in Water
Odor	Petroleum Odor

<u>Property</u>	<u>Test Procedure(AASHTO)</u>	<u>Min</u>	<u>Max</u>
Viscosity, Saybolt-Furol, 122° F	T59	100	400
Sieve Test, %	T59		0.1
Demulsibility, 35ml 0.02 N CaCl ₂ , %	T59	60	
Distillation Test :			
Residue by distillation, % by weight	T59	65	
Oil Distillate, % by volume	T59		0.5
Tests on Residue from Distillation:			
Penetration, 25°C (77°F), 100g, 5 sec	T49	80	130
Float Test, 140°F, sec	T50	1800	
Solubility in Trichloroethylene, %	T44	95	
Elastic Recovery, 50°F, %	T301	55	

Handling Protect emulsion from freezing
 Avoid overheating
 Avoid excessive pumping with high shear pumps

Storage & Application Storage Temperature (°F) 50-185
 Application Temperature (°F) 110-160



RETURN ONLY THE PAGES THAT YOU HAVE BID ON
BID PROPOSAL
CANADIAN COUNTY

DATE: _____ NAME OF FIRM: _____

BIDDER AGREES TO COMPLY WITH ALL TERMS AND CONDITIONS OF BID

S3 VIRGIN HOT MIX ASPHALT – FOB PLANT LOCATION: _____
SPECIFY LOAD MINIMUM _____ PRICE PER TON: _____

S3 RECYCLE* HOT MIX ASPHALT- FOB PLANT LOCATION: _____
up to 25% Recycle Mix (64-22) SPECIFY LOAD MINIMUM _____ PRICE PER TON: _____

S4 VIRGIN HOT MIX ASPHALT- FOB PLANT LOCATION: _____
SPECIFY LOAD MINIMUM _____ PRICE PER TON: _____

S4 RECYCLE* HOT MIX ASPHALT- FOB PLANT LOCATION: _____
up to 25% Recycle Mix (64-22) SPECIFY LOAD MINIMUM _____ PRICE PER TON: _____

*up to 25% Recycle Mix (64-22)

RESPECTFULLY SUBMITTED BY: _____



RETURN ONLY THE PAGES THAT YOU HAVE BID ON
BID PROPOSAL
CANADIAN COUNTY

DATE: _____ NAME OF FIRM: _____

BIDDER AGREES TO COMPLY WITH ALL TERMS AND CONDITIONS OF BID

S3 VIRGIN HOT MIX HAULED & IN PLACE-FOB JOBSITE-PRICE PER TON: 500 TO 2,500 TONS:

EL RENO _____ PIEDMONT _____ WALNUT _____
YUKON _____ MUSTANG _____ GEARY _____
CALUMET _____ UNION CITY _____
MAPLE _____ OKARCHE _____

S3 RECYCLE* HOT MIX HAULED & IN PLACE-FOB JOBSITE-PRICE PER TON: 500 TO 2,500 TONS:

EL RENO _____ PIEDMONT _____ WALNUT _____
YUKON _____ MUSTANG _____ GEARY _____
CALUMET _____ UNION CITY _____
MAPLE _____ OKARCHE _____

S3 VIRGIN HOT MIX HAULED & IN PLACE-FOB JOBSITE-PRICE PER TON: 2,500 or MORE TONS:

EL RENO _____ PIEDMONT _____ WALNUT _____
YUKON _____ MUSTANG _____ GEARY _____
CALUMET _____ UNION CITY _____
MAPLE _____ OKARCHE _____

S3 RECYCLE* HOT MIX HAULED & IN PLACE-FOB JOBSITE-PRICE PER TON: 2,500 or MORE TONS:

EL RENO _____ PIEDMONT _____ WALNUT _____
YUKON _____ MUSTANG _____ GEARY _____
CALUMET _____ UNION CITY _____
MAPLE _____ OKARCHE _____

S4 VIRGIN HOT MIX HAULED & IN PLACE-FOB JOBSITE-PRICE PER TON: 500 TO 2,500 TONS:

EL RENO _____ PIEDMONT _____ WALNUT _____
YUKON _____ MUSTANG _____ GEARY _____
CALUMET _____ UNION CITY _____
MAPLE _____ OKARCHE _____

S4 RECYCLE* & HOT MIX HAULED & IN PLACE-FOB JOBSITE-PRICE PER TON: 500 TO 2,500 TONS:

EL RENO _____ PIEDMONT _____ WALNUT _____
YUKON _____ MUSTANG _____ GEARY _____
CALUMET _____ UNION CITY _____
MAPLE _____ OKARCHE _____

S4 VIRGIN HOT MIX HAULED & IN PLACE-FOB JOBSITE-PRICE PER TON: 2,500 or MORE TONS:

EL RENO _____ PIEDMONT _____ WALNUT _____
YUKON _____ MUSTANG _____ GEARY _____
CALUMET _____ UNION CITY _____
MAPLE _____ OKARCHE _____

S4 RECYCLE* HOT MIX HAULED & IN PLACE-FOB JOBSITE-PRICE PER TON: 2,500 or MORE TONS:

EL RENO _____ PIEDMONT _____ WALNUT _____
YUKON _____ MUSTANG _____ GEARY _____
CALUMET _____ UNION CITY _____
MAPLE _____ OKARCHE _____

*up to 25% Recycle Mix (64-22)

RESPECTFULLY SUBMITTED BY: _____



RETURN ONLY THE PAGES THAT YOU HAVE BID ON
BID PROPOSAL
CANADIAN COUNTY

DATE: _____ NAME OF FIRM: _____

BIDDER AGREES TO COMPLY WITH ALL TERMS AND CONDITIONS OF BID

COLD LAY ASPHALT - PLANT LOCATION: _____

Bulk Plant Pickup: _____

50# Bag: _____

***Specs for Cold Lay:**

- Be workable at a minimum temperature of zero degrees Fahrenheit without being heated
- Adhere to both concrete and asphaltic surfaces that are dry, damp or wet
- Be unaffected by salt or deicing compounds
- Be uniform and not require mixing prior to use

Materials:

Aggregate Gradation and Mixture design: design the mixture with the gradation selected and the asphalt content within the range specified in the chart below.

<u>US Sieve</u>	<u>% passing by weight-Type A</u>
3/4"	100
1/2"	100
3/8"	100
No. 4	65-100
No. 10	20-40
No. 40	5-30
No. 80	0-15
No. 200	0-5

RESPECTFULLY SUBMITTED BY: _____



RETURN ONLY THE PAGES THAT YOU HAVE BID ON
BID PROPOSAL
CANADIAN COUNTY

DATE: NAME OF FIRM:

BIDDER AGREES TO COMPLY WITH ALL TERMS AND CONDITIONS OF BID

SEEKING BIDS FOR MILLING MACHINE SERVICE INCLUDING OPERATOR
DISTRICT YARD WILL HAUL AND TAKE MILLINGS*
ALL TRAFFIC CONTROL AND FLAGGING OPERATIONS TO BE PROVIDED BY COUNTY

ROADWAY MILLING - Price per Project Includes Power Broom and Trimmer for Detailed Work and Clean-Up

PRICE PER SQUARE YARD OF 0" TO 2" DEPTH COLD MILLING - 0 TO 2,500 SY PER ROADWAY MILE:

EL RENO \$ MAPLE \$ UNION CITY \$ WALNUT \$
YUKON \$ PIEDMONT \$ OKARCHE \$ GEARY \$
CALUMETS \$ MUSTANG \$

PRICE PER SQUARE YARD OF 0" TO 2" DEPTH COLD MILLING - 2,500+ SY PER ROADWAY MILE:

EL RENO \$ MAPLE \$ UNION CITY \$ WALNUT \$
YUKON \$ PIEDMONT \$ OKARCHE \$ GEARY \$
CALUMETS \$ MUSTANG \$

PRICE PER SQUARE YARD OF 2" TO 4" DEPTH COLD MILLING - 0 TO 2,500 SY PER ROADWAY MILE:

EL RENO \$ MAPLE \$ UNION CITY \$ WALNUT \$
YUKON \$ PIEDMONT \$ OKARCHE \$ GEARY \$
CALUMETS \$ MUSTANG \$

PRICE PER SQUARE YARD OF 2" TO 4" DEPTH COLD MILLING - 2,500+ SY PER ROADWAY MILE:

EL RENO \$ MAPLE \$ UNION CITY \$ WALNUT \$
YUKON \$ PIEDMONT \$ OKARCHE \$ GEARY \$
CALUMETS \$ MUSTANG \$

PARKING LOTS AND NON-ROADWAY PROJECTS - Price per 8 Hour Day

EL RENO \$ MAPLE \$ UNION CITY \$ WALNUT \$
YUKON \$ PIEDMONT \$ OKARCHE \$ GEARY \$
CALUMETS \$ MUSTANG \$

MOBILIZATION CHARGE - Price per Project Includes To and From Site**

EL RENO \$ MAPLE \$ UNION CITY \$ WALNUT \$
YUKON \$ PIEDMONT \$ OKARCHE \$ GEARY \$
CALUMETS \$ MUSTANG \$

* If Milling Machine waits 30 Minutes for County District Yard Trucks a demurrage fee of \$ per hour will be paid in 15 minute increments after the initial 30 minutes continuing until the end of the standard 8 hour day.

**Additional mobilization will be paid if machine is moved with a trailer to additional site.

RESPECTFULLY SUBMITTED BY:



RETURN ONLY THE PAGES THAT YOU HAVE BID ON
BID PROPOSAL
CANADIAN COUNTY

DATE: _____

NAME OF FIRM: _____

BIDDER AGREES TO COMPLY WITH ALL TERMS AND CONDITIONS OF BID

ROAD ROCK: price per ton:

(All Current ODOT Specifications Apply)

(please specify pit)

Table with 5 columns: Description, FOB, FOB, FOB, FOB. Rows include various rock specifications like *3/8" #2 cover, *5/8" #3 cover, etc.

ON ALL SURGE ROCK, PLEASE SPECIFY 4", 6", 8".

PROCESSED GYP:

PRICE PER TON:

(please specify pit)

Table with 4 columns: Description, PRICE PER TON, PRICE PER TON, PRICE PER TON. Rows include 1/2" crusher run, 3/4" crusher run, etc.

RESPECTFULLY SUBMITTED BY: _____



RETURN ONLY THE PAGES THAT YOU HAVE BID ON
BID PROPOSAL
CANADIAN COUNTY

DATE: _____

NAME OF FIRM: _____

BIDDER AGREES TO COMPLY WITH ALL TERMS AND CONDITIONS OF BID

HAULING OF ROCK - END DUMP TRAILER - PRICE PER TON MILE.

FROM RICHARD SPUR: \$ _____ FROM COOPERTON: \$ _____ FROM TISHOMINGO: \$ _____

FROM GRANITE: \$ _____ FROM CARNEGIE: \$ _____ FROM WATONGA: \$ _____

FROM YUKON: \$ _____ FROM DAVIS: \$ _____

ATTENTION VENDOR: FOR ALL THE ABOVE HAULING LIST NUMBER OF END DUMP TRAILERS THAT ARE AVAILABLE: _____ END

THIS MAY DETERMINE BID AWARD. (MUST HAVE A MINIMUM OF (6) SIX TRUCKS)

HAULING OF ROCK - BELLY DUMP TRAILER - PRICE PER TON MILE.

FROM RICHARD SPUR: \$ _____ FROM COOPERTON: \$ _____ FROM TISHOMINGO: \$ _____

FROM GRANITE: \$ _____ FROM CARNEGIE: \$ _____ FROM WATONGA: \$ _____

FROM YUKON: \$ _____ FROM DAVIS: \$ _____

ATTENTION VENDOR: FOR ALL THE ABOVE HAULING LIST NUMBER OF BELLY DUMP TRAILERS THAT ARE AVAILABLE: _____ BELLY

THIS MAY DETERMINE BID AWARD. (MUST HAVE A MINIMUM OF (6) SIX TRUCKS)

RESPECTFULLY SUBMITTED BY:



Date Issued: May 27, 2025
Bid Number: **SIX MONTH BIDS**
Closing Date: June 13, 2025 at 4:00pm
PO Box 458, 201 N. Choctaw Ave., El Reno, OK 73036
Opening Date: June 16, 2025 during the Commissioner’s Meeting that begins at 9:00am
Commissioner’s Meeting Room, 201 N. Choctaw Ave., El Reno, OK 73036

~ AFFIDAVIT ~
Six Month Bids

State of Oklahoma)
County of Canadian) §

I, Lindsey Garrett, Purchasing Agent, in and for said County and State, do hereby certify that “Notice to Bidder” was sent to the following:

Bid Clerk
projects@bidclerk.com

Bid News Construction
projects@isqft.com

Online Data Services
5425 Peachtree Parkway NW
Peachtree Corners, GA 30092

ePlan
1400 Forum Blvd Ste 7B
Columbia, MO 65203

Reed Construction Data
30 Tech. Pkwy South, Ste 100
Norcross, GA 30092

Arcosa Specialty Materials
Attn: Dillon Price & Tony Nutter
1550 Double Dr.
Norman, OK 73069

Atlas Asphalt Products Inc
Attn: Tyle
PO Box 75727
Oklahoma City, OK 73147

Atlas Paving Co
Attn: Tyle
PO Box 75727
Oklahoma City, OK 73147

Bomhak Trucking
PO Box 400
El Reno, OK 73036

Brown Transportation
PO Box 1748
Ardmore, OK 73402

Coastal Energy Corporation
Attn: Chad Odle
Box 218
#1 Coastal Drive
Willow Springs, MO 65793

Dolese Bros Co
8300 N. Oklahoma Ave
Oklahoma City, OK 73114-7502
projects@dolese.com

Dollar Trucking
PO Box 636
Hennessey, OK 73742

Ergon Asphalt & Emulsions Inc
Attn: Johnny
9301 SW Koch Street
Lawton, OK 73505

Envirotech Services, Inc
Attn: Len Gardner
910 54th Avenue, Ste 230
Greenley, CO 80634
lgardner@envirotechservices.com

Farmers Supply & Transportation Co
PO Box 443
Cheyenne, OK 73628

G.W. Van Keppel Co.
8233 W Reno
Oklahoma City, OK 73127

Haskell Lemon Construction Co
PO Box 75608
Oklahoma City, OK 73147

Hoskins Gypsum Co LLC
PO Box 243
Longdale, OK 73755

Logan County Asphalt
2905 Commerce Blvd
Guthrie, OK 73044

Martin Marietta Materials
8524 S. Western Ave. STE 118
Oklahoma City, OK 73139-9248

Material Service of Oklahoma
Attn: Larry Stewart
PO Box 179
Pawnee, OK 74058

Pateyn Trucking
PO Box 879
Mustang, OK 73064

Railroad Yard
PO Box 2283
Stillwater, OK 74076



**Canadian County
Purchasing**

**Six Month Bids
July 1 – December 31, 2025**

Schwarz Asphalt LLC
8251 W Reno
Oklahoma City, OK 73127

Shoe ValDoc Construction
6600 SW 29th St
Oklahoma City, OK 73179-6002

Sunbelt Equipment & Supply
P.O. Box 130
Meeker, OK 74855

Western Aggregates LLC
8251 West Reno Ave
Oklahoma City, OK 73127

Scotwood Industries LLC
12980 Metcalf Ave, Ste 240
Overland Park, KS 66213

Share Corp
7821 N. Faulkner Rd
Milwaukee, WI 53224

Schwarz Paving Company, Inc
8251 W Reno
Oklahoma City, OK 73127

Blessing Gravel, LLC
4109 South Hutchins Lane
Tishomingo, OK 73460

Trinitas Materials LLC
PO Box 94250
Oklahoma City, OK 73143

Wright Asphalt Products Co
4609 W Meadowlark
Battlefield, MO 65619

Scotwood Industries, Inc
P.O. Box 414809
Kansas City, MO 64141-4809

Oklahoma Concrete Industries
8725 Lehman Rd
El Reno, OK 73036
precastolutionsllc@gmail.com

A&A Trucking, Inc
P.O. Box 75608
Oklahoma City, OK 73147

FirstWater Contracting, LLC
P.O. Box 94250
Oklahoma City, OK 73143

Vance Brothers Inc
4908 N Bryant
Oklahoma City, OK 73121

Zum Mallen Rock & Grain
3212 192nd St. NE
Okarche, OK 73772

SoilChem, LLC
2160 N. Main St. #C-35
Newcastle, OK 73065-5149

Elite Mining and Materials
36198 EW 1330 Road
Wewoka, OK 74884

Witness my hand and seal this 27th day of May, 2025.

Lindsey Garrett, Purchasing Agent (SEAL)



If you have any questions or need additional information, please contact:
Lindsey Garrett, Purchasing Agent, 405.295.6125